

Canadian Standard Fuse Links

4/2

HRCI Fuse Links

GEC ALSTHOM Standard 'AEROFLEX' HRCI current and energy limiting Low Voltage fuse links have been fully tested and CSA approved as meeting the requirements of C22.2 No. 106-M1992.

HRCI fuse links provide both overload and over current protection and can be used in a wide variety of applications.

The standard HRCI-J and HRCI-R fuse links are basically 'fast acting' fuse links and are ideally suited for use on feeder circuits and loads which are mainly resistive.

The 'AEROFLEX' HRCI-J and HRCI-R fuse links have specially designed 'delayed action' time current characteristics and are ideally suited for applications where short time inrush currents are involved such as motor circuit applications.

HRCII Fuse Links

GEC ALSTHOM HRCII-C fuse links are CSA certified for an interrupting duty of 200kA at 600 Volt a.c. They also conform to the requirements of IEC 269 for use at 600 Volt a.c.

GEC ALSTHOM HRCII-C, in common with the 'RED SPOT' range BS 88 part 2 fuse links from which they are derived, provide good all round general purpose characteristics, making them ideally suited for both overload and motor circuit protection.

HRC-L Fuse Links

GEC ALSTHOM HRC-L fuse links provide both overload and short circuit current limiting characteristics in ratings up to 2000 Amps for an interrupting duty of 200kA at 600 Volt a.c.

GEC ALSTHOM HRC-L fuse links are in accordance with and fully approved to CSA standards, for use in a wide variety of applications.

HRCI-MISC Fuse Links

GEC ALSTHOM HRCI-MISC fuse links are generally in accordance with CSA Standards in which no dimensions are specified.

GEC ALSTHOM HRCI-MISC fuse links are fully approved to CSA 22.2 No. 106-M1992 under the HRCI-MISC and HRCI-CA heading for use at 600 Volt a.c. or less.

GEC ALSTHOM HRCI-CS compact fusegear 'CNS' and 'CES' ranges complement the existing range. These fuse links coupled with the Canadian 'SAFECRIP' fuse holders provide a very compact alternative to the conventional North American styles.

List Numbers & Dimensions

Canadian HRCI-R Fuse Links
250 Volt a.c. Type 'HG'

HRCI-R (formerly Form I Class R) fuse links, to CSA specification C22.2 No. 106-M1992 type 'HG' for use at 250 Volt a.c. or less. Breaking capacity 200kA rms.

Characteristics and further details available on request.



Figure 1

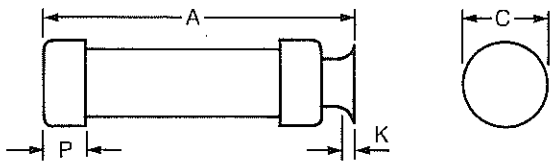
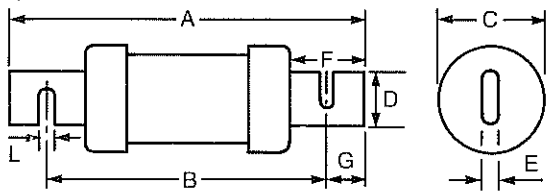

Figure 2



Rating	List number	Dimensions in millimetres Figure 1			
Amp		A	C	K	P
1	C1HG				
3	C3HG				
6	C6HG				
10	C10HG				
15	C15HG	50.8	14.3	4.0	13.5
20	C20HG				
25	C25HG				
30	C30HG				
35	C35HG				
40	C40HG				
45	C45HG	76.2	20.6	4.8	16.7
50	C50HG				
60	C60HG				

Rating	List number	Dimensions in millimetres Figure 2							
		A	B	C	D	E	F	G	L
Amp		Fixing Centres							
70	C70HG								
80	C80HG								
90	C90HG	149.2	123.8	26.2	19.1	3.2	41.3	12.7	7.1
100	C100HG								
110	C110HG								
125	C125HG								
150	C150HG	181.0	146.1	40.5	28.6	4.8	52.4	17.5	7.1
175	C175HG								
200	C200HG								
225	C225HG								
250	C250HG								
300	C300HG	219.1	171.5	53.2	41.3	6.35	69.0	23.8	10.3
350	C350HG								
400	C400HG								
450	C450HG								
500	C500HG	263.5	206.4	63.5	50.8	6.35	90.0	28.6	13.5
600	C600HG								

'HR' fuse link dimensions overleaf

